

WHITE  
CITY  
PLACE

# Available Office Space





Autolus



Synthace



NOVARTIS

maplēree

HUCKLETREE

ROSS

L'ORÉAL  
PARIS

YOOX  
NET-A-PORTER  
GROUP

Cutting Edge Group

OneWeb

PLG  
PARKER LANE GROUP



itv



Join the growing creative hub  
at White City Place.

Following recent lettings,  
the last available office  
space at White City Place is  
disappearing fast. Remaining  
units range from 11,000 sq ft  
to 43,500 sq ft.

Get in touch to book a tour,  
and take the last chance to be  
part of this vibrant destination.

# Schedule of areas

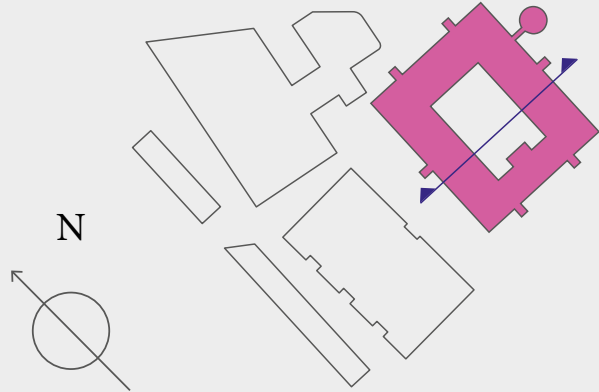

## THE WESTWORKS

FLOOR	AVAILABILITY
THIRD	North West: 14,173 sq ft

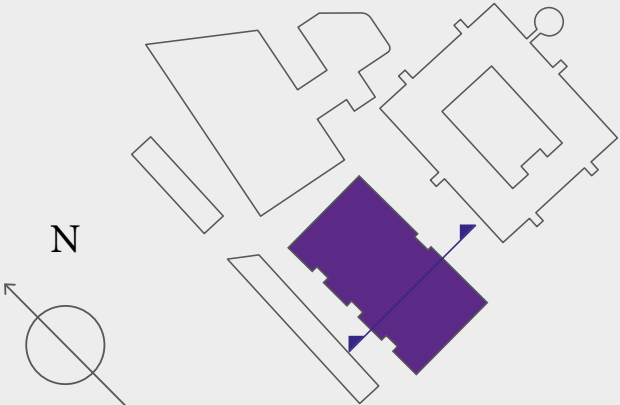

## THE MEDIAWORKS

FLOOR	AVAILABILITY
THIRD	11,551 – 29,566 sq ft
FOURTH	20,057 – 43,592 sq ft



1 ^



3 v



2 ^

# The WestWorks

Join occupiers like ITV, OneWeb and Jellycat in this dynamic office space with a bustling reception area and spacious communal terrace.

## 1 BUTTERSCOTCH

This bakery in the reception area offers delectable sweet treats all day long and a morning porridge bar.

## 2 THE STUDIO

Located on the ground floor of the WestWorks, the Studio is a fully accessible presentation and performance space.

## 3 W12 STUDIOS

Find rotating food vendors and a well-stocked bar in this follow up to Pergola on the Roof.



The WestWorks  
**Floorplans**

- Office available
- Office occupied
- Retail available
- Retail occupied
- Reception
- Communal

Ground floor

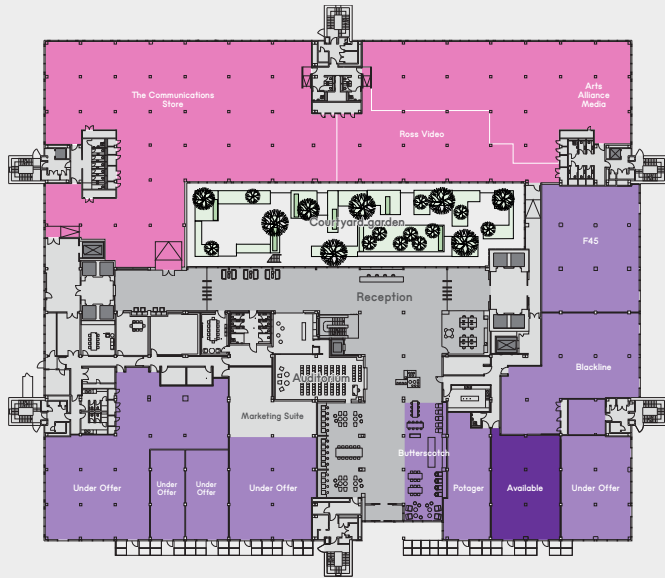

Third floor

Office  
 14,173 sq ft  
 1,300 sq m

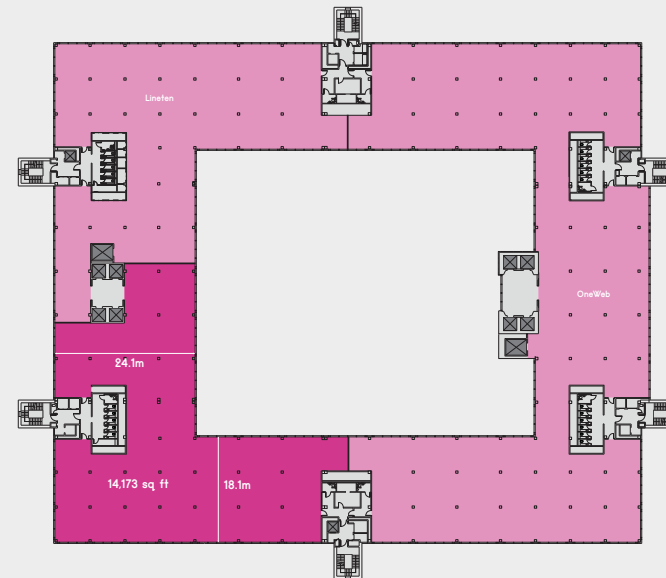

# Specification



## Occupancy

General occupancy:  
1 person per 8 sq m and  
1 person per 10 sq m on ground floor

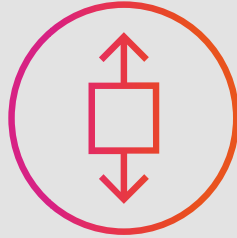

## Lifts

8 passenger lifts each with a capacity  
of 16 persons  
2 goods lifts each with a capacity of  
3200kg / 40 persons  
3 firefighting lifts



## Floor Heights

Clear soffit solution providing 4.1m  
floor-to-soffit on ground floor and  
3.8m on the upper floors

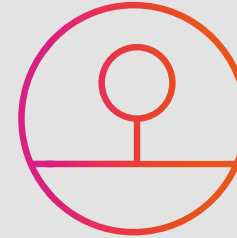

## Amenities

10,000 sq ft communal terrace with  
café pavilion on first floor  
96-seat studio



## Wired Score

Platinum WiredScore rating:  
the highest certification for  
pre-enabled connectivity



## Parking

66 car spaces / 297 bicycle spaces  
300 lockers  
29 showers  
(14 male, 14 female,  
1 accessible)



## Sustainability

BREEAM: Excellent  
EPC: B



## Lighting

New LED lighting and control:  
presence detection  
and daylight sensing



## Ground Floor

Brand new entrance with open plan  
reception/café area  
27,500 sq ft of new ground floor retail



## Communication Provision

Major communications providers  
already on-site include: BT  
Openreach, Colt, EU Networks,  
Verizon, Virgin Media and Vodafone



# White City Place Life

White City Place offers spaces to gather, for the community to meet and share ideas. Relax, eat and drink around a bustling central avenue – or even hold outdoor meetings in comfort with WiFi-enabled public realm.



2 ^

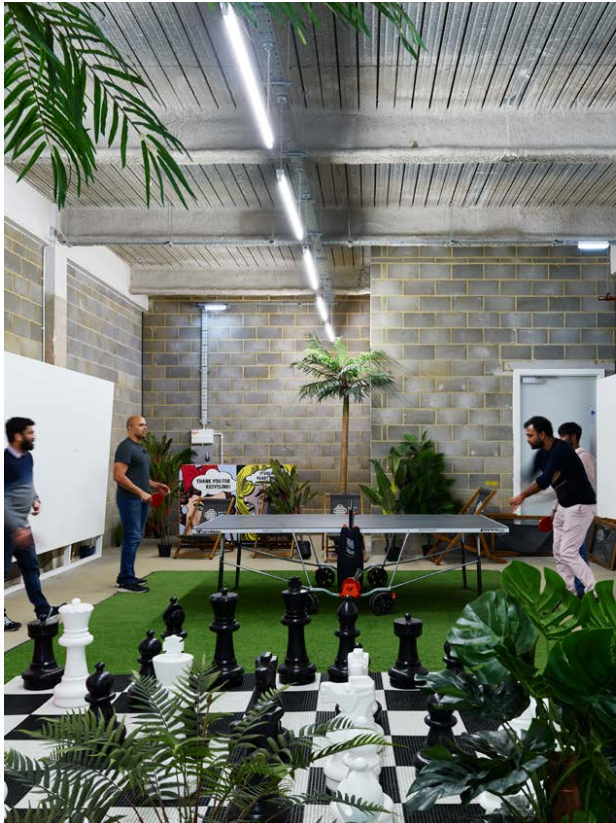

3 ^



## 1 LIFE OUTDOORS

With sporting staples and film classics on the big screen and a regular programme of live music, there's always a reason to relax outside.

## 2 THE POD

The Pod is White City Place's very own recording studio, complete with professional-grade equipment and a friendly team of audio engineers.

## 3 THE GAMES ROOM

The games room in the WestWorks offers table tennis, chess and other games for some downtime and relaxation.



# White City Place

## Retail map

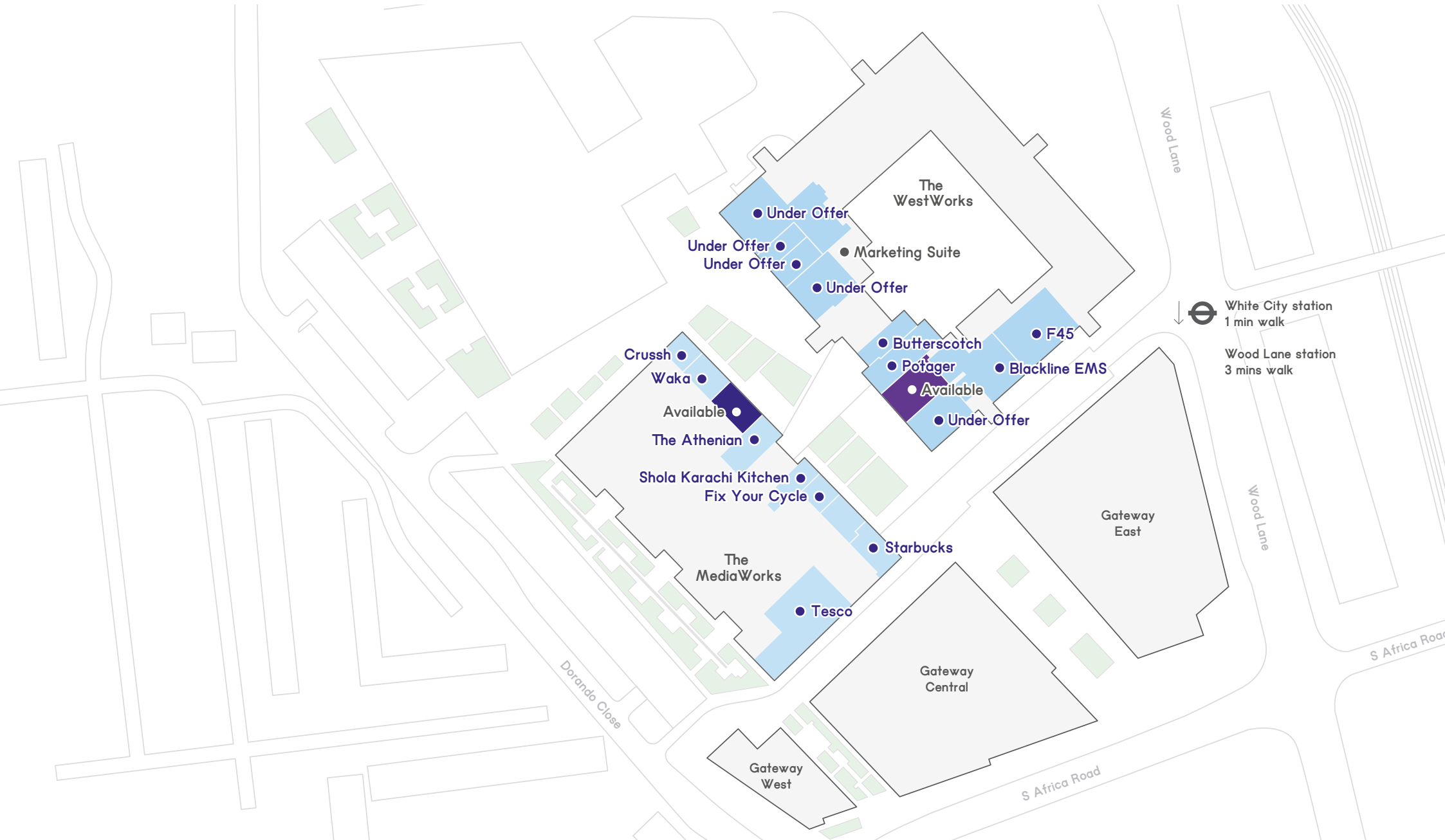



## Contact

### Office Enquiries

Cushman & Wakefield  
Andy Tyler / Joel Randall  
Charles Dady / Henry Harrison  
+44 (0) 20 7935 5000

### Knight Frank

Ian McCarter / Jonny Lee  
Roddy Abram / Andy Nixon  
+44 (0) 20 7629 8171

A development by Cadillac Fairview.  
Asset and development manager, Stanhope.

### Misrepresentation Act:

Knight Frank and Cushman & Wakefield LLP for themselves and for the lessors of this property whose agents they are give notice that: (1) The particulars are set out as a general outline only for the guidance of intending lessees, and do not constitute part of an offer or contract; (2) all descriptions, dimensions, references to condition and necessary permissions for use and occupation, and other details are given in good faith and are believed to be correct, but any intending tenants should not rely on them as statements or representations of fact but satisfy themselves by inspection or otherwise as to the correctness of each of them; (3) no person in the employment of Knight Frank and Cushman & Wakefield LLP has any authority to make or give representation or warranty whatever in relation to this property.  
May 2020.

Written and designed by dn&co. [www.dnco.com](http://www.dnco.com)





THE MEDIOWORKS

NEW RETAIL  
CO-ING SO  
WHITECIT

COCCO

COCCO

COCCO

COCCO