

WHITE
CITY
PLACE

SHAPING THE NEXT GENERATION OF LIFE SCIENCE



STANHOPE AND ONTARIO TEACHERS' PENSION PLAN ARE POWERING THE NEXT GENERATION OF LIFE SCIENCES AT MEDIAWORKS

Join a powerful London ecosystem

Industry leaders including Novartis, Autolus, Engitix and Synthace are among the many science and innovation players who call this cutting-edge campus their home.

Proximity is powerful. White City Place is part of the White City Innovation District, alongside Imperial's 23-acre campus, Scale Space and Hammersmith Hospital providing access to a network of ground breaking innovators and world-leading researchers.

Specialised lab space tailored to you

With four units on the third floor, ranging from 4,101 – 9,677 sq ft 60:40 lab to office ratio, this is a unique, fully fitted laboratory offer.



Private fully fitted CL2 laboratory and office space



Tissue culture rooms



Lab prep and glass clean room with sink



External exhausted fume cupboard



Eye wash stations



Waste and gas store spaces and delivery logistics



Openreach fibre telecoms

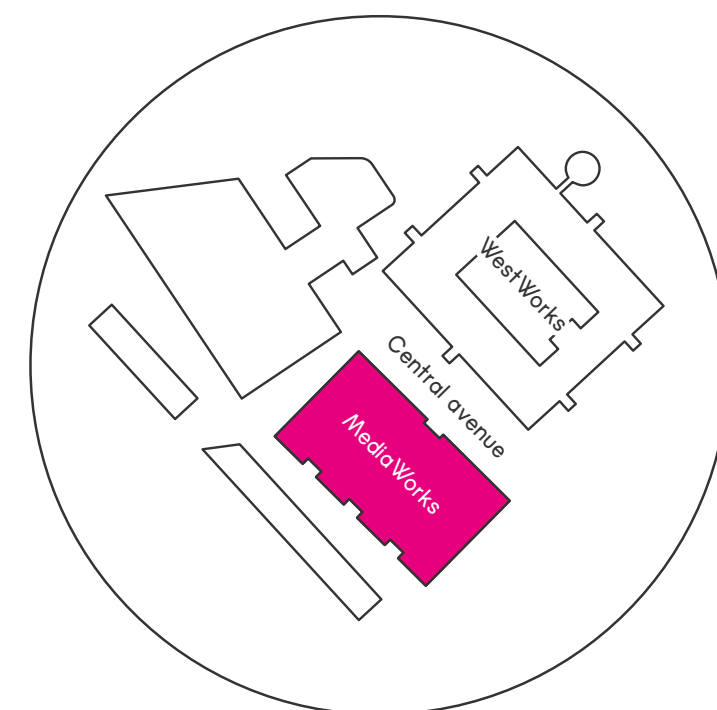

Be part of the ecosystem





LABORATORIES

Containment Level 2 specification

Six air changes per hour

Independent heating and cooling system

Category 5 water protection

Vulcathene drainage

30kVA electrical supply

1 x 1200mm wide-ducted fume cupboard, with capacity to add a second recirculation system

2-3 x hand basin and eye wash station with mirror

Goods lift with safety features to allow transportation of gas bottles

Category 6 flood wiring with Openreach fibre connection

Mix of fully fitted and semi flexible high quality lab benches with shelving, sinks and a mix of under bench drawers and cupboards

External gas storage cage provided in WCP loading bay

OFFICES

Fully fitted office suite including desks, chairs, pedestal cabinets and storage units

Fully fitted kitchenette

Glass meeting rooms with meeting room tables and chairs

Carpeted floor

2.9m floor to ceiling height

400mm raised access floor

8 x 16 person passenger lifts

270 bicycle spaces and 270 lockers

27 showers (13 male, 13 female and 1 accessible)

27% reduction in energy usage achieved in 2023





Laboratory fit out CGI



Office fit out CGI



Fitted tenant kitchen CGI

MEDIAWORKS THIRD FLOOR (SOUTH)

Four units ranging from
4,101 – 9,677 sq ft
60:40 lab to office ratio

	Lab sq ft (NIA)*	Office sq ft (NIA)*	Total sq ft (NIA)*
Unit 1	5,651	4,026	9,677
Unit 2	3,541	1,625	5,166
Unit 3	3,746	1,722	5,468
Unit 4	2,486	1,615	4,101

- Lab
- Office
- Half height IPS station
- Ducted fume hood

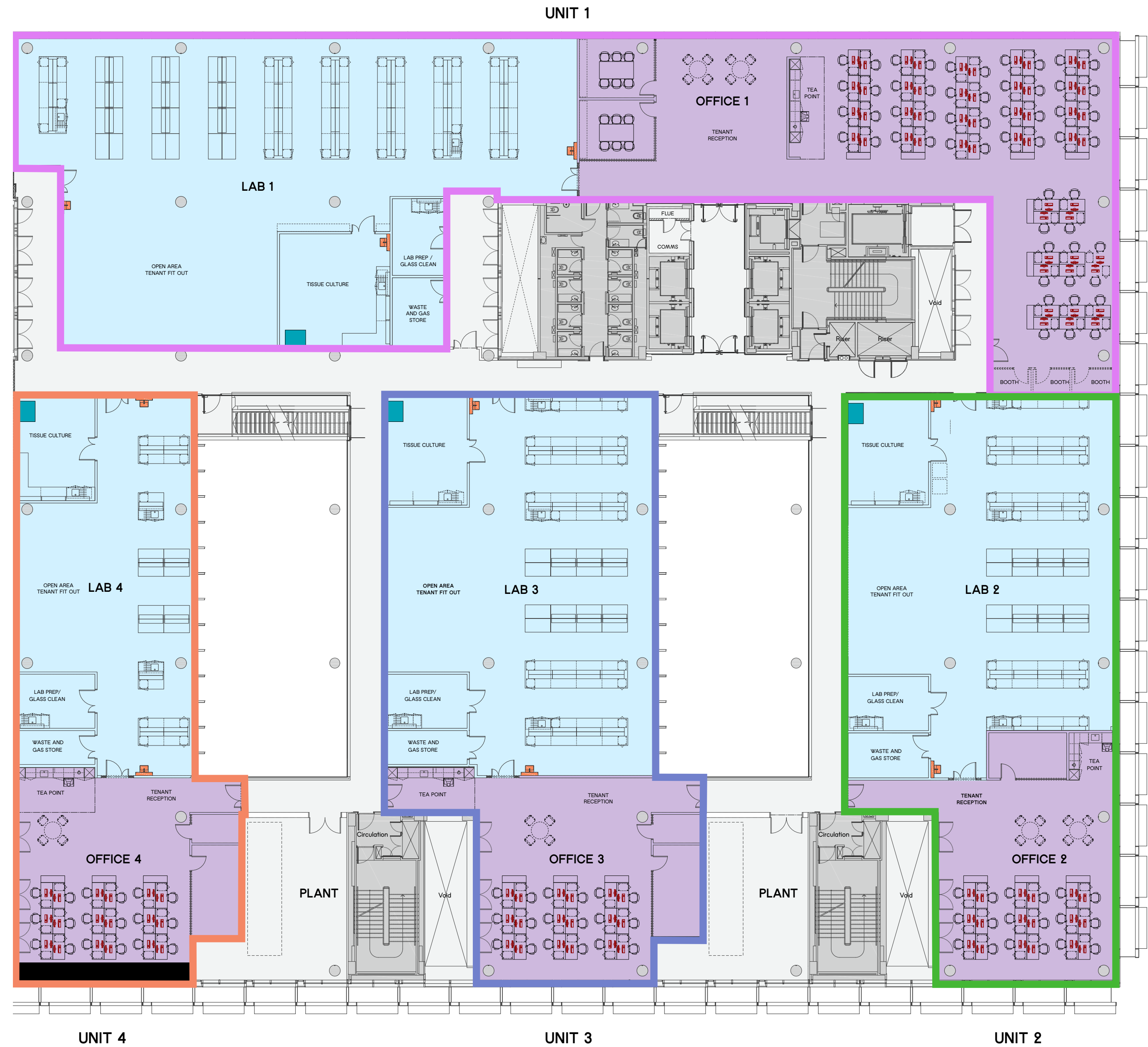
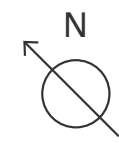
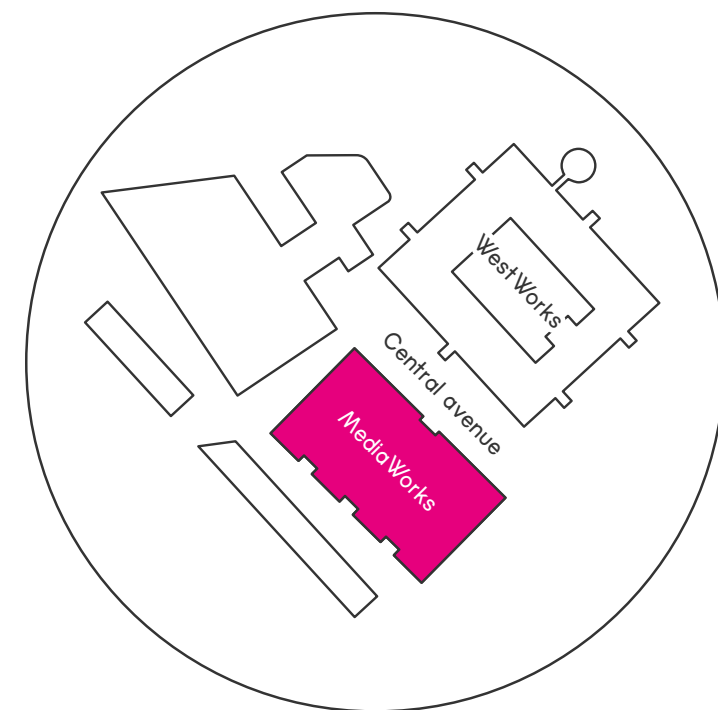

*Approximate Net Internal Area – subject to final measurement

WANT TO ARRANGE A TOUR?

CUSHMAN & WAKEFIELD

Life science:

Jamie Renison
jamie.renison@cushwake.com
+44 (0) 7778 052 594

Harry Blanshard
harry.blanshard@cushwake.com
+44 (0) 7385 950 543

Office:

Andy Tyler
Joel Randall
Charles Dady
Henry Harrison
+44 (0)20 7935 5000

KNIGHT FRANK

Life science:

Emma Goodford
emma.goodford@knightfrank.com
+44 (0) 7831 581 258

Oliver Watkins
oliver.watkins@knightfrank.com
+44 (0) 7976 577 325

Office:

Ian McCarter
Jonny Lee
Roddy Abram
Andy Nixon
+44 (0)20 7629 8171

STANHOPE

Leasing team:

Lara Samworth
Kevin Darvishi
Charlie Russell-Jones
+44 (0)20 7170 1700

To find out more please visit
our website whitecityplace.com

STANHOPE



Misrepresentation Act:

Knight Frank and Cushman & Wakefield LLP for themselves and or the lessors of this property whose agents they are give notice that: (1) The particulars are set out as a general outline only for the guidance of intending lessees, and do not constitute part of an offer or contract; (2) all descriptions, dimensions, references to condition and necessary permissions for use and occupation, and other details are given in good faith and are believed to be correct, but any intending tenants should not rely on them as statements or representations of fact but satisfy themselves by inspection or otherwise as to the correctness of each of them; (3) no person in the employment of Knight Frank and Cushman & Wakefield LLP has any authority to make or give representation or warranty whatever in relation to this property. February 2024.

Designed by DNCO
dnco.com